

Date : 20.01.2021

Submission of Six monthly Compliance report for period June to December 2020_M/s.Bhumi Shelters Pvt Ltd



Green Steps Enviro <greenstepsenviro@gmail.com>
to eccompliance-mh ▾

3:34 PM (0 minutes ago) ☆ ✓ ↶ ⋮

To,
The Additional Principal Chief Conservator of Forests (C)
Ministry of Environment, Forest and climate Change,
West Central Regional Office,
Ground Floor, Eastern Wing,
New Secretariat Building,
Opp. old VCA Stadium,
Civil lines, Nagpur – 440 001

Subject:- Submission of Six Monthly Environmental Compliance Report for period June to December 2020 for our Expansion of Proposed Residential project "Bhumi Silverio" at Gat No.114 (Pt) +124+ 125+126+127 (pt), At Village Chikhali, Tal. Haveli, Pune by M/s. Bhumi Shelters (I.) Pvt.Ltd

Dear Sir / Madam,

This is in reference to Environmental Clearance (Ref.No.SIA/MH/MIS/136980/2020 dated 31st March 2020) accorded from MoEF, GOM to our project

As per Environmental clearance condition iii, we are submitting herewith six monthly compliance environment compliance report for the period June to December 2020.

Kindly acknowledge the same.
Thanking you,
Yours Sincerely,

M/s. Bhumi Shelters (I.) Pvt.Ltd

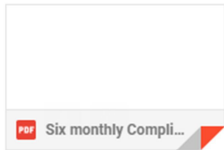

Submission of Six monthly Compliance report for period June to December 2020_M/s.Bhumi Shelters Pvt Ltd



Green Steps Enviro <greenstepsenviro@gmail.com>
to mah-env ▾

3:34 PM (1 minute ago) ☆ ↵ ↶ ⋮

To,
The Member secretary,
Environment department,
Gov. of Maharashtra.
Room no.217, 2nd floor,
Mumbai.400032.

Subject:- Submission of Six Monthly Environmental Compliance Report for period June to December 2020 for our Expansion of Proposed Residential project "Bhumi Silverii" at Gat No.114 (Pt) +124+ 125+126+127 (pt), At Village Chikhali, Tal. Haveli, Pune by M/s. Bhumi Shelters (I.) Pvt.Ltd

Dear Sir / Madam,

This is in reference to Environmental Clearance (Ref.No.SIA/MH/MIS/136980/2020 dated 31st March 2020) accorded from MoEF, GOM to our project

As per Environmental clearance condition iii, we are submitting herewith six monthly compliance environment compliance report for the period June to December 2020.

Kindly acknowledge the same.

Thanking you,
Yours Sincerely,

M/s. Bhumi Shelters (I.) Pvt.Ltd



Activate Windows
Go to Settings to activate Windows.



Date: 20.01.2021

**To,
Maharashtra Pollution Control Board,
3rd Floor, Jog center,
Mumbai-Pune road,
Wakadewadi, Pune.**

Subject: - Submission of Six Monthly Environmental Compliance Report for period June to December 2020 for our Expansion of Proposed Residential project "Bhumi Silverio" at Gat No.114 (Pt) +124+ 125+126+127 (pt), At Village Chikhali, Tal. Haveli, Pune by M/s. Bhumi Shelters (I.) Pvt.Ltd

Dear Sir / Madam,

This is in reference to Environmental Clearance received on dated 31.03.2020 accorded from MoEF, GOM to our project.

As per Environmental clearance condition iii, we are submitting herewith six monthly environment compliance report for period June to December 2020.

Kindly acknowledge the same.

Thanking you,

Yours Sincerely,

M/s. Bhumi Shelters (I.) Pvt.Ltd

Signature



Copy to: 1. The Member secretary, Environment department, Mumbai.
2. The Additional Principal Chief Conservator of Forests (C), Nagpur.

BHUMI SHELTERS (I.)PVT. LTD.

Kapil Vastu, Plot No. PAP-G-123/124, MIDC, G Block, Chinchwad, Pune - 411019 • Tel: 020-27493410

Six monthly Compliance Report

For

Proposed Residential project “Bhumi Silveriio” at Gat No.114
(Pt) +124+ 125+126+127 (pt), At Village Chikhali, Tal. Haveli,
Pune

By

M/s. Bhumi Shelters (I.) Pvt.Ltd

(June to December 2020)

Point wise compliance status to various stipulations laid down by the Government of Maharashtra as per the Environmental Clearance issued vide letter no. **SIA/MH/MIS/136980/2020 dated 31st March, March 2020**

For the Construction activity details. Architectural certificate & status report is attached.

| Sr. No. | Specific conditions | Reply |
|----------------|---|--|
| 1 | Extra parking required for additional 32 flats needs to be accommodated and specific area where they are accommodated needs to be indicated. PP to submit revised parking layout | Parking plan has been prepared by considering requirement of all flats & parking has been accommodated accordingly. Parking plan attached.. |
| 2 | PP to submit evacuation plan for entire project for occupants, visitors and as well as cars. | We have prepared the evacuation time, attached further. |
| 3 | PP to submit CER prescribed by MoEF&CC circular dated 1.5.2018 relevant to the area and people around the project. The specific activities to be undertaken under CER to be carried out in consultation with Municipal Corporation or collector or Environment Department | CER has been prepared & submitted, attached further. |
| 4 | PP Shall comply with Standard EC conditions mentioned in the Office Memorandum issued by MoEF& CC vide F.No.22-34/2018-IA.III dt.04.01.2019 | Noted. |
| S.No. | EC Condition for Construction Phase | Reply |
| 1 | Provision shall be made for the construction labour within the site with all necessary infrastructure and facilities such as fuel for cooking, mobile toilets, mobile STP, safe drinking water, medical health care, creche and First Aid Room etc. | All facilities for labors i.e. fuel for cooking, toilet, safe drinking water, first aid room will be provided once the construction is in full bloom. Creche will be provided on site. At present few labors are present on site for which hutments and mobile toilets are provided. |
| 2 | Adequate drinking water and sanitary facilities should be provided for construction workers at the site. Provision should be made for mobile toilets. The safe disposal of waste water and solid wastes generated during the construction phase should be | Adequate drinking water and sanitary facilities have been provided to the few construction workers present on the site. Please |

| | | |
|---|---|---|
| | ensured. | refer report of quality analysis of provided drinking water. |
| 3 | The solid waste generated should be properly collected and segregated, dry/inert solid waste should be disposed off to the approved sites for the land filling after recovering recyclable material. | During construction phase solid waste generated on site is taken away by Pune Municipal Corporation for which agreement is made. |
| 4 | Disposal of muck during construction phase should not create any adverse effect on the neighboring communities and be disposed taking the necessary precautions for general safety and health aspects of people, only in approved sites with the approval of competent authority. | Construction waste (muck) generated will be reused on site for back filing once the construction is in full bloom. |
| 5 | Arrangement shall be made that waste water and storm water do not get mixed. | Separate arrangement has been made for the disposal of storm water and drainage management. Disposal of storm water will be in storm drain near site and excess treated water will be disposed in sewer line near site. |
| 6 | All the topsoil excavated during construction activities should be stored in horticulture / landscape development within the project site. | Top soil excavated during construction activities has been stored and shall be used for landscape development. |
| 7 | Additional soil for leveling of the proposed site shall be generated within the sites (to the extent possible) so that natural drainage system of the area is protected and improved | Will be complied. |
| 8 | Green Belt Development shall be carried out considering CPCB guidelines including selection of plant species and in consultation with the local DFO/Agriculture Dept. | Landscape area to be provided on ground is 10% on virgin land as required. Also maximum native species has been proposed. Consultation with Agricultural dept will be done during finalization of project. |
| 9 | Soil and ground water samples will be tested to ascertain that there is no threat to ground water | Soil testing has been carried out. Soil monitoring report |

| | | |
|----|---|---|
| | quality by leaching of heavy metals and other toxic contaminants. | is enclosed. Ground water sample will be tested to ascertain that there is no threat to ground water quality by leaching of heavy metals and other toxic contaminants. |
| 10 | Construction spoils, including bituminous material and other hazardous materials must not be allowed to contaminate watercourses and the dump sites for such material must be secured so that they should not leach into the ground water. | Will be complied during construction stages. |
| 11 | Any hazardous waste generated during construction phase should be disposed off as per applicable rules and norms with necessary approvals of the Maharashtra Pollution Control Board | No hazardous waste will be generated during the construction phase. |
| 12 | The diesel generator sets to be used during construction phase should be low sulphur diesel type and should conform to Environments (Protection) Rules prescribed for air and noise emission standards. | The DG sets to be used is of 250 KVA complying to Environments (Protection) Rules prescribed for air and noise emission standards. |
| 13 | The diesel required for operating DG sets shall be stored in underground tanks and if required, clearance from concern authority shall be taken. | DG sets of 250 KVA , will be used during construction phase. The storage of diesel will not be more than 50 lit at a time which will be stored in impervious tank. Since the quantity of diesel is less, no NOC is required for the same. |
| 14 | Vehicles hired for bringing construction material to the site should be in good condition and should have a pollution check certificate and should conform to applicable air and noise emission standards and should be operated only during non peak hours. | Complied. |
| 15 | Ambient noise levels should conform to residential standards both during day and night. Incremental pollution loads on the ambient air and noise quality should be closely monitored during construction phase. Adequate measures should be made to reduce ambient air and noise level during | Air and noise has been monitored and all the values are within the limits. |

| | | |
|----|---|--|
| | construction phase, so as to confirm to the stipulated standards by CPCB/MPCB. | |
| 16 | Fly ash should be used as building material in the construction as per the provisions of Fly Ash Notification of September 1999 and amended as on 27th August, 2003. (The above condition is applicable only if the project site is located within the 100 km of Thermal Power Stations). | Fly ash is using for this project |
| 17 | Ready mixed concrete must be used in building construction | Will be complied |
| 18 | The approval of competent authority shall be obtained for structural safety of the buildings due to any possible earthquake of firefighting equipment's etc. as per National Building Code including measures from lighting. | Structural stability certificate has been obtained |
| 19 | Storm water control and its re-use as per CGWB and BIS standards for various applications. | Appropriate Rain water harvesting system has been proposed for storm water management. |
| 20 | Water demand during construction should be reduced by use of pre-mixed concrete, curing agents and other best practices referred. | Will be complied when the construction will start in full bloom. |
| 21 | The ground water level and its quality should be monitored regularly in consultation with Ground Water Authority. | Ground water will not be used for the project. |
| 22 | The installation of the Sewage Treatment Plant (STP) should be certified by an independent expert and a report in this regard should be submitted to the MPCB and Environment Department before the project is commissioned for operation. Discharged of this unused treated effluent, if any should be discharged in the sewer line. Treated effluent emanating from STP shall be recycled/refused to the maximum extent possible. Discharge of this unused treated effluent, if any should be discharge in the sewer line. Treatment of 100% gray water by decentralized treatment should be done. Necessary measures should be made to mitigate the odor problem from STP. | Will be complied during/after execution of STP. |
| 23 | Permission to draw ground water shall be obtained from the competent Authority prior to construction/operation of the project | NA |

| | | |
|----|---|--|
| 24 | Separation of gray and black water should be done by the use of dual plumbing line for separation of gray and black water. | Dual plumbing is proposed. |
| 25 | Fixtures for showers, toilet flushing and drinking should be of low flow either by use of aerators or pressure reducing devices or sensor based control | Will be complied while installation. |
| 26 | Use of glass may be reduced up to 40% to reduce the electricity consumption and load on air conditioning. If necessary, use high quality double glass with special reflective coating in windows | Glass will be used in windows only. |
| 27 | Roof should meet prescriptive requirement as per Energy Conservation Building Code by using appropriate thermal insulation material to fulfill requirement. | Will be complied at the time of installation |
| 28 | Energy conservation measures like installation of CFLs/TFLs for the lighting the areas outside the building should be integral part of the project design and should be in place before project commissioning. Use CFLs and TFLs should be properly collected and disposed off/sent for recycling as per the prevailing guidelines/rules of the regulatory authority to avoid mercury contamination. Use of solar panels may be done to the extent possible like installing solar street lights, common solar water heaters system. Project proponent should install, after checking feasibility, solar plus hybrid non-conventional energy source as source of energy. | Project proposed to use CFLs/TFLs for common lightning. Lighting power density in compliance with ECBC. Overall energy saving is 21.23% (per day). Solar water heating system is also proposed to suffice the hot water requirement. |
| 29 | Diesel power generating sets proposed as source of back up power for elevators and common area illumination during operation phase should be of enclosed type and conform to rules made under the Environment (Protection) Act, 1986. The height of stack of DG sets should be equal to the height needed for the combined capacity of all proposed DG sets. Use low sulphur diesel. The location of the DG sets may be decided with in consultation with MPCB. | Will be complied at the time of installation. Before operation DG set approved by CPCB/EPA will be used. |
| 30 | Noise should be controlled to ensure that it does not exceed the prescribed standards. During nighttime the noise levels measured at the boundary of the building shall be restricted to the permissible levels to comply with the prevalent | Construction activity will not be carried out during night time. |

| | | |
|--------------|--|---|
| | regulations. | |
| 31 | Traffic congestion near the entry and exit points from the roads adjoining the proposed project site must be avoided. Parking should be fully internalized and no public space should be utilized. | Traffic congestion will be avoided. Internal parking will be provided when the construction will be in full bloom. |
| 32 | Opaque wall should meet prescriptive requirement as per Energy Conservation Building Code, which is proposed to be mandatory for all air-conditioned spaces while it is aspirational for non-air-conditioned spaces by use of appropriate thermal insulation material to fulfill requirement | Will be complied at the time of installation. |
| 33 | The buildings should have adequate distance between them to allow movement of fresh air and passage of natural light, air and ventilation. | The buildings have been planned with adequate distance for fresh air, light and ventilation. |
| 34 | Regular supervision of the above and other measures for monitoring should be in place all through the construction phase, so as to avoid disturbance to the surroundings. | All the environmental practices will be monitored. An organizational set up will be formed to ensure the effective implementation of mitigation measures. |
| 35 | Under the provisions of Environment (Protection) Act, 1986, legal action shall be initiated against the project proponent if it was found that construction of the project has been started without obtaining environmental clearance. | Environmental clearance has been obtained from the Environment Department, Govt. of Maharashtra as per the Environmental Clearance issued vide letter no. SIA/MH/MIS/136980/2020 dated 31st March, March 2020 |
| 36 | Six monthly monitoring reports should be submitted to the Regional office MoEF, Bhopal with copy to this department and MPCB. | Complying. Six monthly compliance report has been submitted to regional office of MoEF, Nagpur |
| S.No. | EC Condition for Post-Construction/Operation Phase | Reply |
| 1 | Project proponent shall ensure completion of STP, MSW disposal Will be complied. As committed no facility, green belt development prior to occupation of the buildings. As agreed during the SEIAA meeting, PP to explore possibility of utilizing | No Occupancy will be given unless all environmental infrastructures are installed and made functional. |

| | | |
|---|---|---|
| | excess treated water in the adjacent are for gardening before discharging it into sewer line. No physical occupation or allotment will be given unless all above said environmental infrastructure is installed and made functional including water requirement in Para 2. prior certification from appropriate authority shall be obtained. | |
| 2 | Wet garbage should be treated by Organic Waste Converter and treated waste (manure) should be utilized in the existing premises for gardening. And no wet garbage will be disposed outside the premises. Local authority should be ensure this. In case of any change(s) in the scope of the project, the project would require a fresh appraisal by this department. | Separate OWC has been proposed for management of wet waste. |
| 3 | Local body should ensure that no occupation certification is issued prior to operation of STP/MSW site etc. with due permission of MPCB. | Noted |
| 4 | A complete set of all the documents submitted to Department should be forwarded to the MPCB | Will be complied before giving the occupancy. |
| 5 | In case of any change(s) in the scope of the project, the project would require a fresh appraisal by this Department | In case of any change, a fresh appraisal will be made to Environment Department. |
| 6 | A separate environment management cell with qualified staff shall be set up for implementation of the stipulated environmental safeguards | Environment Management cell will be appointed for construction and operation phase. |
| 7 | Separate funds shall be allocated for implementation of environmental protection measures/EMP along with item-wise breaks-up. These cost shall be included as part of the project cost. The funds earmarked for the environment protection measures shall not be diverted for other purposes and year-wise expenditure should reported to the MPCB & this department | Will be complied during operation phase. |
| 8 | The project management shall advertise at least in two local newspapers widely circulated in the region around the project one of which shall be in the Marathi language of the local concerned within seven days of issue of this letter, informing that the project has been accorded environmental clearance and copies of clearance letter are available with the | Complied. |

| | | |
|----|--|--|
| | Maharashtra Pollution Control Board and may also be seen at website at http://ec.maharashtra.gov.in . | |
| 9 | Project management should submit half yearly compliance reports in respect of the stipulated prior environment clearance terms and conditions in hard and soft copies to the MPCB & this department, on 1st June & 1st December of each calendar year. | six monthly compliance has been submitted. We will be regularly submitting half yearly compliance reports. |
| 10 | A copy of the clearance letter shall be sent by proponent to the concerned Municipal Corporation and the local NGO, if any, from whom suggestions/representations, if any, were received while processing the proposal. The clearance letter shall also be put on the website of the Company by the proponent. | Will be complied before handing over the occupancy. |
| 11 | The proponent shall upload the status of compliance of the stipulated EC conditions, including results of monitored data on their website and shall update the same periodically. It shall simultaneously be sent to the Regional Office of MoEF, the respective Zonal Office of CPCB and the SPCB. The criteria pollutant levels namely SPM, RSPM, SO ₂ , NO _x (ambient levels as well as stack emissions) or critical sector parameters, indicated for the project shall be monitored and displayed at a convenient location near the main gate of the company in the public domain. | Will be complied before handing over the occupancy. |
| 12 | The project proponent shall also submit six monthly reports on the status of compliance of the stipulated EC conditions results of monitored data (both in hard copies as well as by e- mail) to the respective Regional Office of MoEF, the respective Zonal Office of CPCB and the SPCB. | Will be complied during operation including phase. |
| 13 | The environmental statement for each financial year ending 31st March in Form-V as is mandated to be submitted by the project proponent to the concerned State Pollution Control Board as prescribed under the Environment (Protection) Rules, 1986, as amended subsequently, shall also be put on the website of the company along with the status of compliance of EC conditions and shall also be sent to the respective Regional Offices of MoEF by e-mail. | Will be complied during operation phase. |

| | | |
|---|--|-------|
| | | |
| 4 | The environmental clearance is being issued without prejudice to Noted the action initiated under EP Act or any court case pending in the court of law and it does not mean that project proponent has not violated any environmental laws in the past and whatever decision under EP Act or of the Hon'ble court will be binding on the project proponent. Hence this clearance does not give immunity to the project proponent in the case filed against him, if any or action initiated under EP Act. | Noted |
| 5 | In case of submission of false document and non-compliance of Noted stipulated conditions, Authority/Environment Department will revoke or suspend the Environmental Clearance without any intimation and initiate appropriate legal action under Environmental Protection Act, 1986 | Noted |
| 6 | The Environment department reserves the right to add any stringent condition or to revoke the clearance if conditions stipulated are not implemented to the satisfaction of the department or for that matter, for any other administrative reason | Noted |
| 7 | Validity of Environmental Clearance: The environmental clearance accorded shall be valid for a period of 7 years as per MoEF & CC Notification dated 29th April 2015. | Noted |
| 8 | In case of any deviation or alteration in the project proposed those submitted to this department for clearance, a fresh reference should be made to the department to assess the adequacy of the condition(s) imposed and to incorporate additional environmental protection measures required, if any. | Noted |
| 9 | The above stipulations would be enforced among others under the Noted Water (Prevention and Control of Pollution) Act, 1974, the Air(Prevention and Control of Pollution) Act1 | Noted |

| | | |
|----|---|-------|
| | 1981, the Environment (Protection) Act, 1986 and rules there under, Hazardous Wastes (Management and Handling) Rules, 1989 and its amendments, the public Liability Insurance Act, 1991 and its amendments. | |
| 10 | Any appeal against this environmental clearance shall lie with the Noted National Green Tribunal, Van Vigyan Bhawan, Sec-5, R.K. Puram, New Delhi- 110 022, if preferred, within 30 days as prescribed under Section 16 of the National Green Tribunal Act,2010 | Noted |

LIST OF ANNEXURES

1. Parking plan
2. Evacuation time
3. CER activity chart with Inward letter
4. Declaration by PP regarding CER activities
5. Environmental Clearance letter
6. MPCB Consent to establish
7. Analysis reports
8. Environmental status report
9. Architectural built up certificate
10. Water NOC
11. Drainage NOC
12. Fire NOC

Evacuation plan:

| Particulars | Value | Unit |
|---|--------------|-------------|
| Total no. of the car parked in the total parking lot | 267 | Nos |
| Speed of the car at exit gate | 10 | km/hr |
| Length of car | 5 | m |
| The distance between 2 consecutive cars on the driveway | 1.5 | m |
| Total length of the cars coming out of the building | 1736 | m |
| Time required for exit of last car | 925 | seconds |
| Total evacuation time | 16 | Min. |

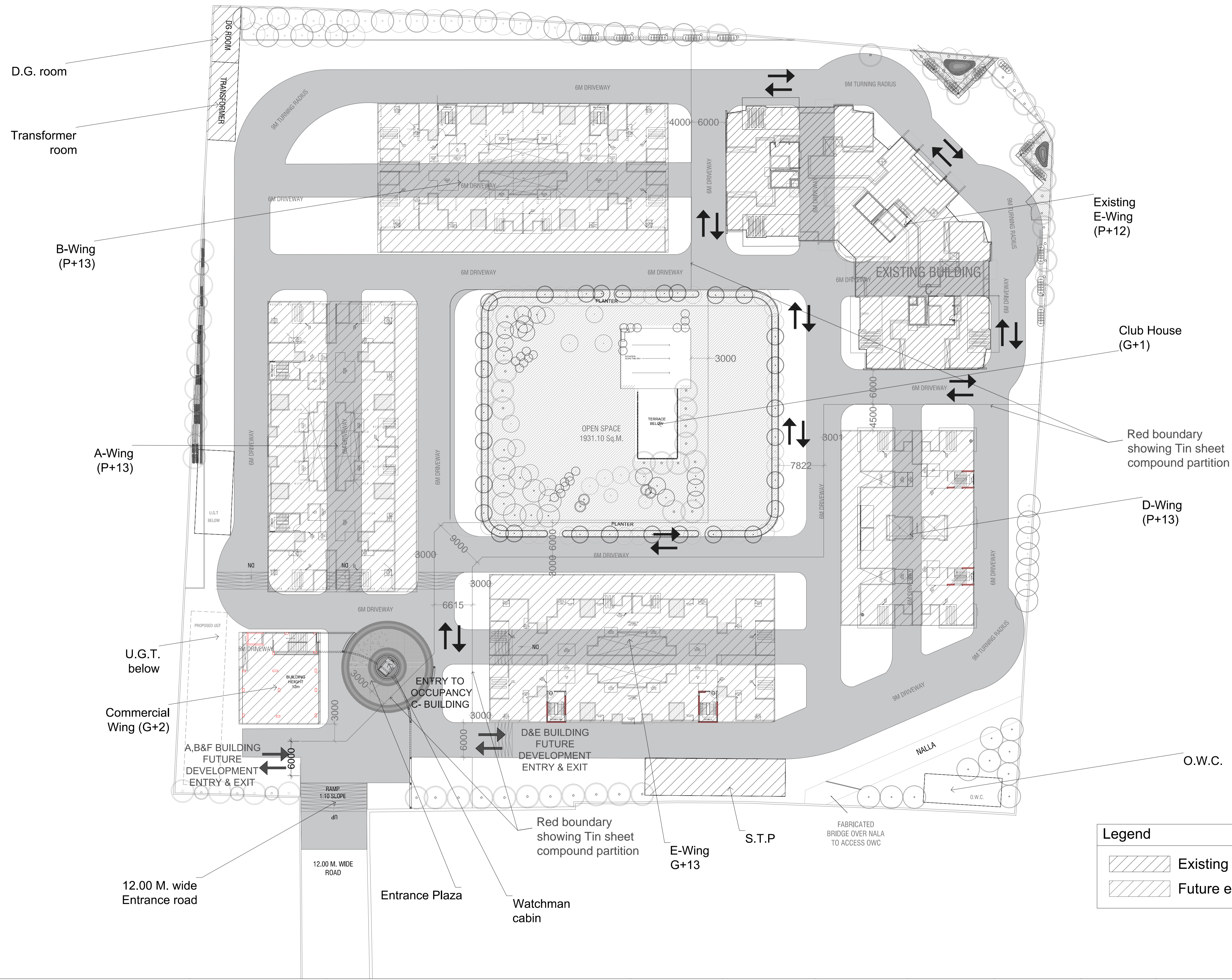

| Legend | |
|--------|--------------------|
| | Existing structure |
| | Future extension |

To
Commissioner,
Pimpri Chinchwad Municipal Corporation,
Pune

Subject: - Inward letter / Report for Corporate Environment Responsibility for the Expansion of Proposed Residential project "Bhumi Silveriio" at Gat No.114 (Pt) +124+125+126+127 (pt), At Village Chikhali, Tal. Haveli, Pune by M/s. Bhumi Shelters (I.) Pvt.Ltd

Ref- As per the circular issued by Ministry of Environment, Forest and Climate Change (MoEFCC) dated May 01, 2018 and subsequent circular of June 19, 2018 on Corporate Environment Responsibility.

Respected Sir / Madam

With reference to the above subject we are enclosing herewith CER report for your reference.
You are requested to accept the same.

Thanks & kind regards

For M/s. Bhumi Shelters (I.) Pvt.Ltd



Mr. D.V.Gunthe & Mr. D.V.More

402/5513/20
लिपीक,
आयुक्त कक्ष
पिंपरी चिंचवड म.न.पा

BHUMI SHELTERS (I.)PVT. LTD.

Corporate Environmental Responsibility (CER)

Name of Project: Expansion of Proposed Residential project “Bhumi Silverii” at Gat No.114 (Pt) +124+ 125+126+127 (pt), At Village Chikhali, Tal. Haveli, Pune by M/s. Bhumi Shelters (I.) Pvt.Ltd

Earlier EC details: Earlier Environment clearance letter vide no. SEIAA-EC-0000001476 on dated 23.04.2019

Cost consideration: Total project cost : Rs. 98.87 Cr

Cost of completion received of Building C: Rs. 16.57 Cr.

Balance cost for consideration: Rs. 82.3 Cr

Cost of CER: 1 % of Project cost i.e. Rs. 82.3 lakh /- (Brown Field Category as per MoEF Notification dated 01.05.2018 & 22.06.2018)

| S. no | CER Activity | Details of CER activity and place of implementation | Name /address of implementing agency | Total Duration of project : 05 years | | | | | Total amount in lakh Rs. |
|-------|-------------------|--|--------------------------------------|--------------------------------------|-------------|-------------|-------------|-------------|--------------------------|
| | | | | 2021 - 2022 | 2022 - 2023 | 2023 - 2024 | 2025 - 2026 | 2026 - 2027 | |
| 1 | RWH | Rain water harvesting for Municipality school of – 1.PCMC School no. 108 , Dudulgaon 2. PCMC school no. 89, Kudalwadi Total no. of recharge pits will be proposed: 04 no’s. | M/s. Bhumi Shelters (I.) Pvt.Ltd | 0 | 02 | 2.5 | 0 | 0 | 4.5 |
| 2 | Avenue Plantation | Road side Plantation in - 1. Existing 30 m wide Dehu- Alandi road for stretch of 2000 m span. Total no. of trees required : 1600 (both side of road) 2. Existing 12 m road for stretch of 500 m | | 10 | 10 | 3.5 | 05 | 05 | 38 |

| | | | | | | | | | |
|--------------|--------------|---|----------------------------------|--|--|--|--|--|----------------------|
| | | span. Total no. of trees required : 400 (both side of road) Cost per tree sample : 350 Rs. , Tree guard: 85 Rs per tree , Other cost (pits , fertilizers, watering & management , transportation & planting) Total no. of tree : 2000 | | | | | | | |
| 03 | Solar street | Installation of solar street lights on – 1. Existing 30 m wide Dehu- Alandi road for stretch of 2000 m span. (400 street lights will be placed on both sides of road). 2. Existing 12 m road for stretch of 500 m span (100 street lights will be placed on both sides of road). Cost per street light sample: 3000 Rs. Solar panel light -Rs. 3000, Aluminum pole – Rs. 1500 also cost of other cost(Excavation , footing , wiring , etc) | M/s. Bhumi Shelters (I.) Pvt.Ltd | | | | | | 40 |
| TOTAL | | | | | | | | | Rs. 82.5 lakh |

For M/s. Bhumi Shelters (I.) Pvt.Ltd



Mr. D.V.Gunthe & Mr. D.V.More



UNDERTAKING

We have submitted the CER activities as per the Notification of Expansion of Proposed Residential project "Bhumi Silveriio" at Gat No.114 (Pt) +124+125+126+127 (pt), At Village Chikhali, Tal. Haveli, Pune by M/s. Bhumi Shelters (I.) Pvt.Ltd to SEAC, SEIAA, Govt. of Maharashtra as well as to PCMC at the time of Environmental clearance procedure.

Further we have not initiated any proposed activities under CER because due to COVID-19 pandemic & lockdown the construction activities was stopped on site.

Thanks & kind regards

For M/s. Bhumi Shelters (I.) Pvt.Ltd

Mr. D.V.Gunthe & Mr. D.V.More

BHUMI SHELTERS (I.)PVT. LTD.

Kapil Vastu, Plot No. PAP-G-123/124, MIDC, G Block, Chinchwad, Pune - 411019 • Tel: 020-27493410

STATE LEVEL ENVIRONMENT IMPACT ASSESSMENT AUTHORITY

No. SIA/MH/MIS/136980/2020
Environment Department
Room No. 217, 2nd Floor,
Mantralaya,
Mumbai- 400032.
Date: 31.03.2020.

To
M/s. Bhumi Shelters (I.) Pvt.Ltd
Gat No.114 (Pt) +124+ 125+126+127 (pt),
At Village Chikhali, Tal. Haveli, Pune

Subject : Environment Clearance for Expansion of Proposed Residential project
“Bhumi Silverii” at Gat No.114 (Pt) +124+ 125+126+127 (pt), At Village
Chikhali, Tal. Haveli, Pune by M/s. Bhumi Shelters (I.) Pvt.Ltd

Reference : Application no. SIA/MH/MIS/136980/2020

This has reference to your communication on the above mentioned subject. The proposal was considered by the SEAC-III in its 106th meeting under screening category 8 (a) B2 as per EIA Notification, 2006 and recommend to SEIAA. Proposal then considered in 197th meeting of State Level Environment Impact Assessment Authority (SEIAA)

2. Brief Information of the project submitted by you is as below:-

| | | | |
|--|--|---------------------|----------------|
| Project Name | Expansion of Proposed Residential project “Bhumi Silverii” at Gat No.114 (Pt) +124+ 125+126+127 (pt), At Village Chikhali, Tal. Haveli, Pune by M/s. Bhumi Shelters (I.) Pvt.Ltd | | |
| Plot area | 19459.32 sq. m | | |
| FSI | 29,307.54 sq. m | | |
| Non FSI | 33,187.43 sq. m | | |
| Total Built up area | 62,494.54 sq. m | | |
| Building configuration | Building Name & Number | Number of floors | Height (Mtrs.) |
| | Building A | Parking + 13 floors | 41.95 |
| | Building B | Parking + 13 floors | 41.95 |
| | Building C(Existing) | Parking + 12 floors | 38.55 |
| | Building D | Parking + 13 floors | 41.95 |
| | Building E | Ground + 13 floors | 41.95 |
| | Commercial | Ground + 2 floors | 11.40 |
| | Club house | Ground + 1 floor | 7.95 |
| No. of flats & Total population | Residential : 513 ;Commercial : Shops & Offices Total population : 2655 no's Residential : 2565 no's Commercial bldg./Floating population: 90 | | |
| Water requirement | 362.33 KLD | | |
| Sewage generation | 315 KLD | | |
| STP Capacity & Technology | STP – 330 KLD Technology : MBBR | | |
| STP location | Open to Sky | | |
| RG area required & provided – mother earth | RG area mandatory & provided (10 %) : 1931.10 sq.mt | | |

| | |
|---------------------------------------|---|
| & podium | |
| Energy requirement | Connected load : 5942 Kw Demand load : 1204 KW Total energy saving : 21.23 % |
| Energy saving total By solar | 16.81 % |
| No. of DG sets & capacities | 1 Nos. 250 KVA |
| Solid waste generation | Total – 1352.30 Kg/Day |
| Bio-degradable generation | 805.22 Kg/Day |
| Non-Biodegradable | 547.08 Kg/Day |
| OWC capacities | 850 Kg/Day |
| Parking | |
| 2 - Wheeler | 1056 Nos. |
| Bicycle | 1036 Nos. |
| 4- Wheeler | 267 Nos. |
| EMP cost | Construction phase : Capital cost : 16.28 Lakhs Operation phase: Capital cost : 214.4 Lakhs ; O/M cost : 51.96 Lakhs/year |
| Rain water harvesting | |
| No. of pits & size of pits | 09 Nos. 2.25 m. X 2.25 m. X 1.75 m |
| Details of UG tanks & no. of capacity | Domestic : 391.28 KLD Flushing : 113.76 KLD Fire : 300 KLD |
| CER | Budget Allocation Rs. 82.3 Lakh |

3. The proposal has been considered by SEIAA in its 197th meeting and decided to accord Environment Clearance to the said project under the provisions of Environment Impact Assessment Notification, 2006 subject to implantation of following terms and conditions-

Specific Conditions:

- I. Extra parking required for additional 32 flats needs to be accommodated and specific area where they are accommodated needs to be indicated. PP to submit revised parking layout
- II. PP to submit evacuation plan for entire project for occupants, visitors and as well as cars.
- III. There is no septic tank constructed on site and sewage is disposed off directly to municipal sewer. PP to obtained specific NOC from competent authority.
- IV. PP to submit CER prescribed by MoEF&CC circular dated 1.5.2018 relevant to the area and people around the project. The specific activities to be undertaken under CER to be carried out in consultation with Municipal Corporation or collector or Environment Department.
- V. PP Shall comply with Standard EC conditions mentioned in the Office Memorandum issued by MoEF& CC vide F.No.22-34/2018-IA.III dt.04.01.2019
- VI. SEIAA decided to grant Environment Clearance FSI: 29307.54 m², Non-FSI:32391.72 m² and Total BUA: 61699.26 m²(Plan Approval no-BP/EC/Chikhali/03/2019, dated-18.10.2019)

General Conditions:

- i. E-waste shall be disposed through Authorized vendor as per E-waste (Management and Handling) Rules, 2016.

- ii. The Occupancy Certificate shall be issued by the Local Planning Authority to the project only after ensuring sustained availability of drinking water, connectivity of sewer line to the project site and proper disposal of treated water as per environmental norms.
- iii. This environmental clearance is issued subject to obtaining NOC from Forestry & Wild life angle including clearance from the standing committee of the National Board for Wild life as if applicable & this environment clearance does not necessarily implies that Forestry & Wild life clearance granted to the project which will be considered separately on merit.
- iv. PP has to abide by the conditions stipulated by SEAC& SEIAA.
- v. The height, Construction built up area of proposed construction shall be in accordance with the existing FSI/FAR norms of the urban local body & it should ensure the same along with survey number before approving layout plan & before according commencement certificate to proposed work. Plan approving authority should also ensure the zoning permissibility for the proposed project as per the approved development plan of the area.
- vi. If applicable Consent for Establishment" shall be obtained from Maharashtra Pollution Control Board under Air and Water Act and a copy shall be submitted to the Environment department before start of any construction work at the site.
- vii. All required sanitary and hygienic measures should be in place before starting construction activities and to be maintained throughout the construction phase.
- viii. Adequate drinking water and sanitary facilities should be provided for construction workers at the site. Provision should be made for mobile toilets. The safe disposal of wastewater and solid wastes generated during the construction phase should be ensured.
- ix. The solid waste generated should be properly collected and segregated. Dry/inert solid waste should be disposed of to the approved sites for land filling after recovering recyclable material.
- x. Disposal of muck during construction phase should not create any adverse effect on the neighbouring communities and be disposed taking the necessary precautions for general safety and health aspects of people, only in approved sites with the approval of competent authority.
- xi. Arrangement shall be made that waste water and storm water do not get mixed.
- xii. All the topsoil excavated during construction activities should be stored for use in horticulture / landscape development within the project site.
- xiii. Additional soil for levelling of the proposed site shall be generated within the sites (to the extent possible) so that natural drainage system of the area is protected and improved.
- xiv. Green Belt Development shall be carried out considering CPCB guidelines including selection of plant species and in consultation with the local DFO/ Agriculture Dept.
- xv. Soil and ground water samples will be tested to ascertain that there is no threat to ground water quality by leaching of heavy metals and other toxic contaminants.
- xvi. Construction spoils, including bituminous material and other hazardous materials must not be allowed to contaminate watercourses and the dumpsites for such material must be secured so that they should not leach into the ground water.
- xvii. Any hazardous waste generated during construction phase should be disposed of as per applicable rules and norms with necessary approvals of the Maharashtra Pollution Control Board.
- xviii. The diesel generator sets to be used during construction phase should be low sulphur diesel type and should conform to Environments (Protection) Rules prescribed for air and noise emission standards.
- xix. The diesel required for operating DG sets shall be stored in underground tanks and if required, clearance from concern authority shall be taken.
- xx. Vehicles hired for bringing construction material to the site should be in good condition and should have a pollution check certificate and should conform to applicable air and noise emission standards and should be operated only during non-peak hours.
- xxi. Ambient noise levels should conform to residential standards both during day and night. Incremental pollution loads on the ambient air and noise quality should be closely monitored during construction phase. Adequate measures should be made to reduce ambient air and noise level during construction phase, so as to conform to the stipulated standards by CPCB/MPCB.

- xxii. Fly ash should be used as building material in the construction as per the provisions of Fly Ash Notification of September 1999 and amended as on 27th August, 2003. (The above condition is applicable only if the project site is located within the 100Km of Thermal Power Stations).
- xxiii. Ready mixed concrete must be used in building construction.
- xxiv. Storm water control and its re-use as per CGWB and BIS standards for various applications.
- xxv. Water demand during construction should be reduced by use of pre-mixed concrete, curing agents and other best practices referred.
- xxvi. The ground water level and its quality should be monitored regularly in consultation with Ground Water Authority.³
- xxvii. The installation of the Sewage Treatment Plant (STP) should be certified by an independent expert and a report in this regard should be submitted to the MPCB and Environment department before the project is commissioned for operation. Discharge of this unused treated effluent, if any should be discharge in the sewer line. Treated effluent emanating from STP shall be recycled/ refused to the maximum extent possible. Discharge of this unused treated effluent, if any should be discharge in the sewer line. Treatment of 100% grey water by decentralized treatment should be done. Necessary measures should be made to mitigate the odour problem from STP.
- xxviii. Permission to draw ground water and construction of basement if any shall be obtained from the competent Authority prior to construction/operation of the project.
- xxix. Separation of grey and black water should be done by the use of dual plumbing line for separation of grey and black water.
- xxx. Fixtures for showers, toilet flushing and drinking should be of low flow either by use of aerators or pressure reducing devices or sensor based control.
- xxxi. Use of glass may be reduced up to 40% to reduce the electricity consumption and load on air conditioning. If necessary, use high quality double glass with special reflective coating in windows.
- xxxii. Roof should meet prescriptive requirement as per Energy Conservation Building Code by using appropriate thermal insulation material to fulfil requirement.
- xxxiii. Energy conservation measures like installation of CFLs /TFLs for the lighting the areas outside the building should be integral part of the project design and should be in place before project commissioning. Use CFLs and TFLs should be properly collected and disposed of /sent for recycling as per the prevailing guidelines/rules of the regulatory authority to avoid mercury contamination. Use of solar panels may be done to the extent possible like installing solar street lights, common solar water heaters system. Project proponent should install, after checking feasibility, solar plus hybrid non-conventional energy source as source of energy.
- xxxiv. Diesel power generating sets proposed as source of backup power for elevators and common area illumination during operation phase should be of enclosed type and conform to rules made under the Environment (Protection) Act, 1986. The height of stack of DG sets should be equal to the height needed for the combined capacity of all proposed DG sets. Use low sulphur diesel. The location of the DG sets may be decided with in consultation with Maharashtra Pollution Control Board.
- xxxv. Noise should be controlled to ensure that it does not exceed the prescribed standards. During night-time the noise levels measured at the boundary of the building shall be restricted to the permissible levels to comply with the prevalent regulations.
- xxxvi. Traffic congestion near the entry and exit points from the roads adjoining the proposed project site must be avoided. Parking should be fully internalized and no public space should be utilized.
- xxxvii. Opaque wall should meet prescriptive requirement as per Energy Conservation Building Code, which is proposed to be mandatory for all air-conditioned spaces while it is aspiration for non-air-conditioned spaces by use of appropriate thermal insulation material to fulfil requirement.
- xxxviii. The building should have adequate distance between them to allow movement of fresh air and passage of natural light, air and ventilation.
- xxxix. Regular supervision of the above and other measures for monitoring should be in place all through the construction phase, so as to avoid disturbance to the surroundings.
- xl. Under the provisions of Environment (Protection) Act, 1986, legal action shall be initiated against the project proponent if it was found that construction of the project has been started without obtaining environmental clearance.

- xli. Six monthly monitoring reports should be submitted to the Regional office MoEF, Bhopal with copy to this department and MPCB.
- xlii. Project proponent shall ensure completion of STP, MSW disposal facility, green belt development prior to occupation of the buildings. As agreed during the SEIAA meeting, PP to explore possibility of utilizing excess treated water in the adjacent area for gardening before discharging it into sewer line. No physical occupation or allotment will be given unless all above said environmental infrastructure is installed and made functional including water requirement in Para 2. Prior certification from appropriate authority shall be obtained.
- xlili. Wet garbage should be treated by Organic Waste Converter and treated waste (manure) should be utilized in the existing premises for gardening. And, no wet garbage will be disposed outside the premises. Local authority should ensure this.
- xliv. Local body should ensure that no occupation certification is issued prior to operation of STP/MSW site etc. with due permission of MPCB.
- xlv. A complete set of all the documents submitted to Department should be forwarded to the Local authority and MPCB.
- xlvi. In the case of any change(s) in the scope of the project, the project would require a fresh appraisal by this Department.
- xlvii. A separate environment management cell with qualified staff shall be set up for implementation of the stipulated environmental safeguards.
- xlviii. Separate funds shall be allocated for implementation of environmental protection measures/EMP along with item-wise breaks-up. These cost shall be included as part of the project cost. The funds earmarked for the environment protection measures shall not be diverted for other purposes and year-wise expenditure should reported to the MPCB & this department.
- xlix. The project management shall advertise at least in two local newspapers widely circulated in the region around the project, one of which shall be in the Marathi language of the local concerned within seven days of issue of this letter, informing that the project has been accorded environmental clearance and copies of clearance letter are available with the Maharashtra Pollution Control Board and may also be seen at Website at <http://parivesh.nic.in>
 1. Project management should submit half yearly compliance reports in respect of the stipulated prior environment clearance terms and conditions in hard & soft copies to the MPCB & this department, on 1st June & 1st December of each calendar year.
 - li. A copy of the clearance letter shall be sent by proponent to the concerned Municipal Corporation and the local NGO, if any, from whom suggestions/representations, if any, were received while processing the proposal. The clearance letter shall also be put on the website of the Company by the proponent.
 - lii. The proponent shall upload the status of compliance of the stipulated EC conditions, including results of monitored data on their website and shall update the same periodically. It shall simultaneously be sent to the Regional Office of MoEF, the respective Zonal Office of CPCB and the SPCB. The criteria pollutant levels namely; SPM, RSPM, SO₂, NO_x (ambient levels as well as stack emissions) or critical sector parameters, indicated for the project shall be monitored and displayed at a convenient location near the main gate of the company in the public domain.
 - liii. The project proponent shall also submit six monthly reports on the status of compliance of the stipulated EC conditions including results of monitored data (both in hard copies as well as by e-mail) to the respective Regional Office of MoEF, the respective Zonal Office of CPCB and the SPCB.
 - liv. The environmental statement for each financial year ending 31st March in Form-V as is mandated to be submitted by the project proponent to the concerned State Pollution Control Board as prescribed under the Environment (Protection) Rules, 1986, as amended subsequently, shall also be put on the website of the company along with the status of compliance of EC conditions and shall also be sent to the respective Regional Offices of MoEF by e-mail.
4. The environmental clearance is being issued without prejudice to the action initiated under EP Act or any court case pending in the court of law and it does not mean that project proponent has not violated any environmental laws in the past and whatever decision under EP Act or of the Hon'ble court will

- be binding on the project proponent. Hence this clearance does not give immunity to the project proponent in the case filed against him, if any or action initiated under EP Act.
5. In case of submission of false document and non-compliance of stipulated conditions, Authority/ Environment Department will revoke or suspend the Environment clearance without any intimation and initiate appropriate legal action under Environmental Protection Act, 1986.
 6. The Environment department reserves the right to add any stringent condition or to revoke the clearance if conditions stipulated are not implemented to the satisfaction of the department or for that matter, for any other administrative reason.
 7. Validity of Environment Clearance: The environmental clearance accorded shall be valid as per EIA Notification, 2006, amended time to time.
 8. In case of any deviation or alteration in the project proposed from those submitted to this department for clearance, a fresh reference should be made to the department to assess the adequacy of the condition(s) imposed and to incorporate additional environmental protection measures required, if any.
 9. The above stipulations would be enforced among others under the Water (Prevention and Control of Pollution) Act, 1974, the Air (Prevention and Control of Pollution) Act, 1981, the Environment (Protection) Act, 1986 and rules there under, Hazardous Wastes (Management and Handling) Rules, 1989 and its amendments, the public Liability Insurance Act, 1991 and its amendments.
 10. Any appeal against this Environment clearance shall lie with the National Green Tribunal (Western Zone Bench, Pune), New Administrative Building, 1st Floor, D-Wing, Opposite Council Hall, Pune, if preferred, within 30 days as prescribed under Section 16 of the National Green Tribunal Act, 2010.

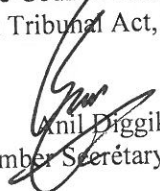
Anil Diggikar
(Member Secretary, SEIAA)

Copy to:

1. Shri Johny Joseph, Chairman, SEIAA.
2. Secretary, MoEF & CC
3. IA- Division MOEF & CC
4. Member Secretary, Maharashtra Pollution Control Board, Mumbai.
5. Regional Office MoEF & CC, Nagpur
6. District Collector, Pune
7. Commissioner, Pimpri chinchwad Municipal Corporation
8. Regional Officer, Maharashtra Pollution Control Board, Pune



MAHARASHTRA POLLUTION CONTROL BOARD

Tel: 24010706/24010437
Fax: 24044532/4024068/4023516
Website: <http://mpcb.gov.in>
Email: jdwater@mpcb.gov.in



Kalpataru Point, 2nd and
4th floor, Opp. Cine Planet
Cinema, Near Sion Circle,
Sion (E), Mumbai-400022

Infrastructure/RED/L.S.I

No:- Format 1.0/JD (WPC)/UAN No.0000103435/CE - 2102001209

Date: 22.02.2021

To,
M/s. Bhumi Shelters,
"Bhumi Silverio" at Gat No.114 (Pt)
+124+ 125+126+127 (pt),
At : Village, Chikhali, Tal: : Pune-Pune

Sub: Revalidation of Consent to Establish with expansion for Construction of Residential Project granted Under Red Category

Ref: 1. Consent to establish granted format 1.0/BO/ROHQ/CE/PN-19145-13/CC-2824 dt.24/03/2014

Your application NO. MPCB-CONSENT-0000103435

For: grant of revalidation of Consent to Establish with expansion under Section 25 of the Water (Prevention & Control of Pollution) Act, 1974 & under Section 21 of the Air (Prevention & Control of Pollution) Act, 1981 and Authorization / Renewal of Authorization under Rule 6 of the Hazardous & Other Wastes (Management & Transboundary Movement) Rules 2016 is considered and the consent is hereby granted subject to the following terms and conditions and as detailed in the schedule I, II, III & IV annexed to this order:

1. **Revalidation of consent to establish is granted period for COU or up to 31/03/2024**
2. **The capital investment of the project is Rs.16.21 [Existing CI 57.25 cr + proposed CI-166.21, Total CI=73.46] (As per undertaking submitted by pp).**
3. **The revalidation of Consent to Establish with expansion is valid for proposed residential projects named as Bhumi Shelters, "Bhumi Silverio" at Gat No.114 (Pt) +124+ 125+126+127 (pt), At Village, Chikhali, Pune on total Plot Area of 19459.32 SqMtrs for construction BUA of 62494.54 SqMtrs as per EC granted date 31/03/2020 including utilities and services and commencement Certificate issued by local body.**

| Sr.No | Permission Obtained | Plot Area (SqMtr) | BUA (SqMtr) |
|-------|--|-------------------|-------------|
| 1 | Environmental Clearance dt. 31/03/2020 | 19459.32 | 62494.54 |

4. **Conditions under Water (P&CP), 1974 Act for discharge of effluent:**

| Sr No | Description | Permitted (in CMD) | Standards to | Disposal |
|-------|-------------------|--------------------|---------------------|--|
| 1. | Trade effluent | Nil | 0 | 0 |
| 2. | Domestic effluent | 315 | As per Schedule - I | The treated effluent shall be 60% recycled for secondary purposes such as toilet flushing, air conditioning, cooling tower make up, firefighting etc. and remaining shall be connected to the sewerage system provided by local body |



5. **Conditions under Air (P& CP) Act, 1981 for air emissions:**

| Stack No. | Description of stack / source | Number of Stack | Standards to be achieved |
|-----------|-------------------------------|-----------------|--------------------------|
| S-1 | D.G. Set 250 KVA | 1 | As per Schedule -II |

6. **Conditions under Solid Waste Rules, 2016:**

| Sr No | Type Of Waste | Quantity & UoM | Treatment | Disposal |
|-------|---------------|----------------|--|---|
| 1 | Wet garbage | 805.22 Kg/Day | Organics waste Converter with composting facility / Biogas digester with composting facility | used as Manure |
| 2 | Dry Garbage | 547.08 Kg/Day | - | Segregate and Hand over to Local Body for recycling |

7. **Conditions under Hazardous & Other Wastes (M & T M) Rules 2016 for treatment and disposal of hazardous waste:**

| Sr No | Category No. | Quantity | UoM | Treatment | Disposal |
|-------|--------------|----------|-----|-----------|----------|
| NA | | | | | |

- 8 This Board reserves the right to review, amend, suspend, revoke etc. this consent and the same shall be binding on the industry.
- 9 This consent should not be construed as exemption from obtaining necessary NOC/permission from any other Government agencies.
- 10 The treated effluent shall be 60% recycled for secondary purposes such as toilet flushing, air conditioning, cooling tower make up, firefighting etc. and remaining shall be utilized on land for gardening.
- 11 PP shall install online monitoring system for BOD, TSS and flow at the outlet of STP with connectivity to MPCB Server.
- 12 PP shall install organic waste digester along with composting facility/biodigester (biogas) with composting facility for the treatment of wet garbage.
- 13 Project proponent shall not use groundwater till obtain permission from Central Ground Water Authority (CGWA)

For and on behalf of the
Maharashtra Pollution Control Board.

Dr. Y.B.Sontakke
Joint Director (WPC)

Received Consent fee of -

| Sr.No | Amount(Rs.) | Transaction/DR.No. | Date | Transaction Type |
|-------|-------------|--------------------|------------|------------------|
| 1 | 50000.00 | MPCB-DR-3130 | 10/12/2020 | NEFT |
| 2 | 75000.00 | MPCB-DR-4457 | 16/02/2021 | NEFT |

Copy to:

1. Regional Officer, MPCB, Pune and Sub-Regional Officer, MPCB, Pimpri-Chinchwad
- They are directed to ensure the compliance of the consent conditions.
2. Chief Accounts Officer, MPCB, Sion, Mumbai



SCHEDULE-I

Terms & conditions for compliance of Water Pollution Control:

- 1) A] As per your application, you have proposed to provide MBBR based Sewage Treatment Plants (STPs) of combined capacity **330 CMD for treatment of domestic effluent of 315 CMD.**
- B] The Applicant shall operate the sewage treatment plant (STP) to treat the sewage so as to achieve the following standards prescribed by the Board or under EP Act, 1986 and Rules made there under from time to time, whichever is stringent.

| Sr.No | Parameters | Limiting concentration not to exceed in mg/l, except for pH |
|-------|----------------|---|
| 1 | pH | 5.5-9.0 |
| 2 | BOD | 10 |
| 3 | COD | 50 |
| 4 | TSS | 20 |
| 5 | NH4 N | 5 |
| 6 | N-total | 10 |
| 7 | Fecal Coliform | less than 100 |

- C] The treated domestic effluent shall be 60% recycled for secondary purposes such as toilet flushing, air conditioning, cooling tower make up, firefighting etc. and remaining shall be utilized on land for gardening and connected to the sewerage system provided by local body.
- 2) The Board reserves its rights to review plans, specifications or other data relating to plant setup for the treatment of waterworks for the purification thereof & the system for the disposal of sewage or trade effluent or in connection with the grant of any consent conditions. The Applicant shall obtain prior consent of the Board to take steps to establish the unit or establish any treatment and disposal system or and extension or addition thereto.
- 3) The industry shall ensure replacement of pollution control system or its parts after expiry of its expected life as defined by manufacturer so as to ensure the compliance of standards and safety of the operation thereof.
- 4) **The Applicant shall comply with the provisions of the Water (Prevention & Control of Pollution) Act,1974 and as amended, and other provisions as contained in the said act.**

| Sr. No. | Purpose for water consumed | Water consumption quantity (CMD) |
|---------|--|----------------------------------|
| 1. | Industrial Cooling, spraying in mine pits or boiler feed | 0.00 |
| 2. | Domestic purpose | 362.33 |
| 3. | Processing whereby water gets polluted & pollutants are easily biodegradable | 0.00 |
| 4. | Processing whereby water gets polluted & pollutants are not easily biodegradable and are toxic | 0.00 |

- 5) The Applicant shall provide Specific Water Pollution control system as per the conditions of EP Act, 1986 and rule made there under from time to time.



SCHEDULE-II

Terms & conditions for compliance of Air Pollution Control:

- 1) As per your application, you have proposed to provide the Air pollution control (APC) system and also proposed to erect following stack (s) and to observe the following fuel pattern-

| Stack No. | Stack Attached To | APC System | Height in Mtrs. | Type of Fuel | Quantity & UoM |
|-----------|-------------------|---------------------|-----------------|--------------|----------------|
| S-1 | D.G. Set 250 | Accoustic enclosure | 3.16 | HSD | 75 Ltr/Hr |

- 2) The applicant shall operate and maintain above mentioned air pollution control system, so as to achieve the level of pollutants to the following standards.

| | | |
|-------------------------|---------------|------------------------|
| Total Particular matter | Not to exceed | 150 mg/Nm ³ |
|-------------------------|---------------|------------------------|

- 3) The Applicant shall obtain necessary prior permission for providing additional control equipment with necessary specifications and operation thereof or alteration or replacement/alteration well before its life come to an end or erection of new pollution control equipment.
- 4) The Board reserves its rights to vary all or any of the condition in the consent, if due to any technological improvement or otherwise such variation (including the change of any control equipment, other in whole or in part is necessary).
- 5) **Conditions for utilities like Kitchen, Eating Places, Canteens:-**
- The kitchen shall be provided with exhaust system chimney with oil catcher connected to chimney through ducting.
 - The toilet shall be provided with exhaust system connected to chimney through ducting.
 - The air conditioner shall be vibration proof and the noise shall not exceed 68 dB(A).
 - The exhaust hot air from A.C. shall be attached to Chimney at least 5 mtrs. higher than the nearest tallest building through ducting and shall discharge into open air in such a way that no nuisance is caused to neighbors.

SCHEDULE-III

Details of Bank Guarantees:

| Sr. No. | Consent (C2E/C2O/C2R) | Amt of BG Imposed | Submission Period | Purpose of BG | Compliance Period | Validity Date |
|---------|-----------------------|-------------------|-------------------|------------------------------------|------------------------------------|------------------------------------|
| 1 | Consent to Establish | 10.0 lakh | 15 days | compliance consent conditions & EC | Up to Commissioning of the project | Up to Commissioning of the project |

** The above Bank Guarantee(s) shall be submitted by the applicant in favour of Regional Officer at the respective Regional Office within 15 days of the date of issue of Consent.
Existing BG obtained for above purpose if any may be extended for period of validity as above.

BG Forfeiture History

| Srno. | Consent (C2E/C2O/C2R) | Amount of BG imposed | Submission Period | Purpose of BG | Amount of BG Forfeiture | Reason of BG Forfeiture |
|-------|-----------------------|----------------------|-------------------|---------------|-------------------------|-------------------------|
| NA | | | | | | |



BG Return details

| Srno. | Consent (C2E/C2O/C2R) | BG imposed Purpose of BG | Amount of BG Returned |
|-------|-----------------------|--------------------------|-----------------------|
| | | NA | |

SCHEDULE-IV

Conditions during construction phase

| | |
|----------|--|
| A | During construction phase, applicant shall provide temporary sewage and MSW treatment and disposal facility for the staff and worker quarters. |
| B | During construction phase, the ambient air and noise quality shall be maintained and should be closely monitored through MoEF approved laboratory. |
| C | Noise should be controlled to ensure that it does not exceed the prescribed standards. During night time the noise levels measured at the boundary of the building shall be restricted to the permissible levels to comply with the prevalent regulations. |

General Conditions:

- 1 The applicant shall provide facility for collection of samples of sewage effluents, air emissions and hazardous waste to the Board staff at the terminal or designated points and shall pay to the Board for the services rendered in this behalf.
- 2 The firm shall strictly comply with the Water (P&CP) Act, 1974, Air (P&CP) Act, 1981 and Environmental Protection Act 1986 and Solid Waste Management Rule 2016, Noise (Pollution and Control) Rules, 2000 and E-Waste (Management & Handling Rule 2011.
- 3 Drainage system shall be provided for collection of sewage effluents. Terminal manholes shall be provided at the end of the collection system with arrangement for measuring the flow. No sewage shall be admitted in the pipes/sewers downstream of the terminal manholes. No sewage shall find its way other than in designed and provided collection system.
- 4 Vehicles hired for bringing construction material to the site should be in good condition and should conform to applicable air and noise emission standards and should be operated only during non-peak hours.
- 5 Conditions for D.G. Set
 - a) Noise from the D.G. Set should be controlled by providing an acoustic enclosure or by treating the room acoustically.
 - b) Industry should provide acoustic enclosure for control of noise. The acoustic enclosure/ acoustic treatment of the room should be designed for minimum 25 dB (A) insertion loss or for meeting the ambient noise standards, whichever is on higher side. A suitable exhaust muffler with insertion loss of 25 dB (A) shall also be provided. The measurement of insertion loss will be done at different points at 0.5 meters from acoustic enclosure/room and then average.
 - c) Industry should make efforts to bring down noise level due to DG set, outside industrial premises, within ambient noise requirements by proper siting and control measures.
 - d) Installation of DG Set must be strictly in compliance with recommendations of DG Set manufacturer.
 - e) A proper routine and preventive maintenance procedure for DG set should be set and followed in consultation with the DG manufacturer which would help to prevent noise levels of DG set from deteriorating with use.
 - f) D.G. Set shall be operated only in case of power failure.

- g) The applicant should not cause any nuisance in the surrounding area due to operation of D.G. Set.
- h) The applicant shall comply with the notification of MoEFCC, India on Environment (Protection) second Amendment Rules vide GSR 371(E) dated 17.05.2002 and its amendments regarding noise limit for generator sets run with diesel.
- 6 Solid Waste - The applicant shall provide onsite municipal solid waste processing system & shall comply with Solid Waste Management Rule 2016 & E-Waste (M & H) Rule 2011.
- 7 Affidavit undertaking in respect of no change in the status of consent conditions and compliance of the consent conditions the draft can be downloaded from the official web site of the MPCB.
- 8 Applicant shall submit official e-mail address and any change will be duly informed to the MPCB.
- 9 The treated sewage shall be disinfected using suitable disinfection method.
- 10 The firm shall submit to this office, the 30th day of September every year, the environment statement report for the financial year ending 31st march in the prescribed Form-V as per the provision of rule 14 of the Environmental (Protection) Second Amended rule 1992.
- 11 The applicant shall obtain Consent to Operate from Maharashtra Pollution Control Board before commissioning of the project.

For and on behalf of the
Maharashtra Pollution Control Board.

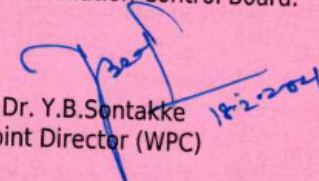
Dr. Y.B. Sontakke
Joint Director (WPC)



Ambient Air Quality Monitoring Report

| | | |
|--|----------------------------|---------------------------------|
| Name of Client & Address: Proposed Residential project “Bhumi Silverio” at Gat No.114 (Pt) +124+ 125+126+127 (pt), At Village Chikhali, Tal. Haveli, Pune By M/s. Bhumi Shelters (I.) Pvt.Ltd | Date of Report | 21/11/2020 |
| | Sample Location | Near Main /Entry Gate |
| | Sample Collected By | Green EnviroSafe |
| | Sample type | Ambient Air |
| | Date of Sampling | 17/11/2020 |
| | Time of Sampling | 10:30 am. |
| | Sampling Duration | 08 Hrs. |
| | Analysis Date | 18/11/2020 to 21/11/2020 |

| Sr. No. | Parameter | Result | Unit | NAAQ Standards | Standard Method |
|---------|---------------------------------------|--------|-------------------|----------------|---|
| 1 | Ambient Temperature | 35 | °C | | Standard RTD Elements |
| 2 | Relative Humidity | 42 | % RH | | Solid-state Capacitive Sensor |
| 3 | Sulphur Dioxide (SO ₂) | 11.5 | µg/M ³ | ≤ 80 | IS : 5182 (Part 2)-2001 |
| 4 | Oxides of Nitrogen (NO _x) | 20.03 | µg/M ³ | ≤ 80 | IS : 5182 (Part 6)-2006 |
| 5 | Particulate Matter PM ₁₀ | 45.6 | µg/M ³ | ≤ 100 | USEPA (40 CFR Ch.-1)Appendix J to Part 50 |
| 6 | Particulate Matter PM _{2.5} | 16.74 | µg/M ³ | ≤ 60 | USEPA (40 CFR Ch.-1)Appendix L to Part 50 |
| 7 | Carbon Monoxide (CO) | BDL | mg/M ³ | ≤ 04 | IS : 5182 (Part 10)-1999 |

REMARKS / OBSERVATIONS:

- All above results are within National Ambient Air Quality Standards.
- BDL = Below Detectable Limit

| | | |
|--|---|--|
| ANALYZED BY-  |  | AUTHORIZED SIGNATORY  |
|--|---|--|

Ambient Noise Monitoring Report

| | | |
|--|----------------------------|--|
| Name of Client & Address: Proposed Residential project "Bhumi Silverio" at Gat No.114 (Pt) +124+ 125+126+127 (pt), At Village Chikhali, Tal. Haveli, Pune By M/s. Bhumi Shelters (I.) Pvt.Ltd | Date of Report | 21/11/2020 |
| | Sample Collected By | Green EnviroSafe |
| | Sample type | Noise |
| | Date of Sampling | 17/11/2020 |
| | Reporting date | 21/11/2020 |
| | Instrument Details | Sound Level Meter, Sr. No.12126740 Calibrated on -25.01.2020, Due on -25.01.2021 |

| Sr. No. | Test Location | Readings | Unit |
|---------|----------------------|-------------------------------|-------|
| | | Day Time 12:30 pm. Onwards | |
| 1 | Near Main/Entry Gate | 55.0 | dB(A) |
| 2 | Near DG Set | 56.0 | dB(A) |

REMARKS / OBSERVATIONS:

- **Limits:** Maharashtra Pollution Control Board has prescribed 55 dB (A) as an upper limit of Noise Level during day time and 45 dB (A) during night time.

AMBIENT NOISE LEVEL STATNDARDS

| Category of Area | Limits in dB (A) Leq | |
|------------------|-----------------------------------|-------------------------------------|
| | Day Time (6.00 am to 10.00 pm) | Night Time (10.00 pm to 6.00 am) |
| Industrial Area | 75 | 70 |
| Commercial Area | 65 | 55 |
| Residential Area | 55 | 45 |
| Silence Zone | 50 | 40 |

| | | |
|---|---|---|
| ANALYZED BY-  |  | AUTHORIZED SIGNATORY  |
|---|---|---|

Test Report

| | | |
|---|--|---------------------------------|
| Name of Client & Address: Proposed Residential project "Bhumi Silverii" at Gat No.114 (Pt) +124+125+126+127 (pt), At Village Chikhali, Tal. Haveli, Pune By M/s. Bhumi Shelters (I.) Pvt.Ltd | Date of Report | 21/11/2020 |
| | Sample Collected By | Green EnviroSafe |
| | Method for Sampling | IS:3025 Part -1 |
| | Sample Type | Drinking Water |
| | Sample Collected On | 17/11/2020 |
| | Sample Received on | 17/11/2020 |
| | Analysis Date | 18/11/2020 to 21/11/2020 |
| | Reporting Date | 21/11/2020 |
| Sample returned /stored | Stored at 4°C for 1 week from the date of reporting | |

| Sr. No. | Parameter | Result | Limits as per IS 10500-2012 | Unit | Standard Method |
|--------------------------------|------------------------|-----------|-----------------------------|-----------|---|
| Physical Parameter | | | | | |
| 1 | E. Conductivity | 710.5 | -- | µS | IS: 3025 Part-04 (R.A : 2002) |
| 2 | Total Dissolved Solids | 285 | <500 | mg/lit | IS: 3025 Part-05 (R.A : 2002) |
| 3 | Turbidity | 0.78 | <1.0 | NTU | IS: 3025 Part-10 (R.A : 2002) |
| 4 | Colour | 1 | <5 | Hazen | IS: 3025 Part-16 (R.A : 2006) |
| 5 | Odour | Agreeable | Agreeable | -- | IS: 3025 Part-04 (R.A : 2002) |
| Chemical Parameter | | | | | |
| 1 | pH | 7.89 | 6.5-8.5 | -- | IS: 3025 Part-11 (R.A : 2002) |
| 2 | Total Hardness | 114.02 | <200 | mg/lit | IS: 3025 Part-14 (R.A : 2002) |
| 3 | Total Alkalinity | 114.36 | <200 | mg/lit | IS: 3025 Part-21 (2009) |
| 4 | Chloride | 90.26 | <250 | mg/lit | IS: 3025 Part-23 (R.A : 2003) |
| 5 | Sulphate | 87.5 | <200 | mg/lit | IS: 3025 Part-32 (R.A : 2003) |
| 6 | Residual Chlorine | Nil | >0.2 | mg/lit | APHA :22 nd edition -(4500- SO ₄ ²⁻ E) |
| 7 | Calcium | 8.44 | <75 | mg/lit | IS: 3025 Part-02 (2004) |
| 8 | Magnesium | 7.10 | <30 | mg/lit | IS: 3025 Part-02 (2004) |
| 9 | Iron | Nil | <0.3 | mg/lit | IS: 3025 Part-02 (2004) |
| Microbiological Testing | | | | | |
| 1 | Total Coliform | < 2 | Absent | MPN/100ml | IS: 1622 (R.A : 1996) |
| 2 | <i>E.coli</i> | < 2 | Absent | MPN/100ml | IS: 1622 (R.A : 1996) |

Note : For *E.coli* and Coliform <2 can be considered as Absent

➤ The tests marked with an * are not accredited by NABL

REMARKS / OBSERVATIONS: All above parameters are within limits as per IS: 10500(2012) standards.

| | | |
|---|---|---|
| ANALYZED BY-  |  | AUTHORIZED SIGNATORY  |
|---|---|---|

| Test Report | | |
|---|---|---------------------------------|
| Name of Client & Address: Proposed Residential project "Bhumi Silverio" at Gat No.114 (Pt) +124+125+126+127 (pt), At Village Chikhali, Tal. Haveli, Pune By M/s. Bhumi Shelters (I.) Pvt.Ltd | Date of Report | 21/11/2020 |
| | Sample Name | Soil Sample |
| | Sample Collected By | Green EnviroSafe |
| | Method for Sampling | -- |
| | Sample Type | Soil |
| | Sample Collected On | 17/11/2020 |
| | Sample Received on | 17/11/2020 |
| | Analysis Date | 18/11/2020 to 21/11/2020 |
| | Reporting Date | 21/11/2020 |
| Sample returned /stored | Stored at room temp. for 1 week from the date of reporting | |

| Sr. No. | Parameter | | Result | Unit |
|---------------------------|----------------------------|------|---------|---------|
| Physical Parameter | | | | |
| 1. | Moisture Content | | 7.55 | percent |
| 2. | Organic Matter | | 1.13 | percent |
| 3. | Particle Size Distribution | Sand | 14 | percent |
| | | Silt | 55 | percent |
| | | Clay | 21 | percent |
| Chemical Parameter | | | | |
| 1. | pH (1:5) | | 8.09 | - |
| 2. | Electrical Conductivity | | 134 | µS/cm |
| 3. | SAR Ratio | | 0.54 | -- |
| 4. | Total Nitrogen | | 129.9 | mg/kg |
| Elemental Testing | | | | |
| 1. | Potassium (as K) | | 1260.89 | mg/kg |
| 2. | Phosphorous (as P) | | 60.0 | mg/kg |
| 3. | Iron (as Fe) | | 407.25 | mg/kg |
| 4. | Copper (as Cu) | | 142.7 | mg/kg |

| | | |
|--|---|--|
| ANALYZED BY-  |  | AUTHORIZED SIGNATORY  |
|--|---|--|

-----End of Report-----

Date: - 22.01.2021

TO WHOM SO EVER IT MAY CONCERN

Subject: - Proposed Site "Silverio" situated at Gat.No.114 (Pt) +124+125+126+ 127(Pt), Chikhali, Pune.

Clients Name: - M/s Bhumi Shelters (I) Pvt. Ltd. Through Mr. D.V. Gunthe (Director)

Dear Sir,

Architectural details as below;

| Sr. No. | Particulars | Date | Proposed FSI (Sq.M) | Proposed Non-FSI (Sq.M) | Proposed total BUA (Sq.M) | Status Actual Construction carried till date (Sq.M) | Remarks |
|---------|--|--|---|-------------------------|---------------------------|---|---------|
| 1 | Plan Approval /I.O.I /I.O.D & Chronological Amendments | 18/10/2019 | Bldg. A+B+D+E+ Commercial (F) = 22746.03 & Club House- 283.24 , Existing C Bldg =6561.51 | 25131.01 | 48160.28 | 1) C-bldg. = 13538.98 2) Commercial bldg. G. Fl. =148.93 3) Security cabin= 10.00 4) U.G.T.= 160.00 | - |
| 2 | Commencement Certificate and Chronological Amendments | 1)06/10/2012 2)14/08/2014 3)15/07/2019 4)02/01/2020 | - | - | - | - | - |
| 3 | Proposed Built up Area | - | Bldg. A+B+D+E+ Commercial (F) = 22746.03 & Club House- 283.24 , Existing C Bldg = 6561.51 | 25131.01 | 48160.28 | 1) C-bldg. = 13538.98 2) Commercial bldg. G. Fl. =148.93 3) Security cabin= 10.00 4) U.G.T.= 160.00 5) Club House- Gr. Floor = 188.86 | - |
| 4 | Occupation Certificate | C Bldg. - 15/07/2019 | - | - | - | - | - |
| 5 | Previous EC granted if any | 23/04/2019 | 27001.10 | 21157.44 | 48158.54 | - | - |
| 6 | Approved EC on | 31/03/2020 | 29307.54 | 33187.43 | 62494.54 | - | - |

This letter is issued as technical information only and Ar. Avinash Nawathe will not be involved in any legal disputes arising of this letter.

This certificate is issued on 22.01.2021, as per the information & request of the client.

Avinash Nawathe
Architect



ANA, 7th Floor, Mantri Sterling, Behind Manikchand Galleria,
Off SB Road, Shivaji Nagar, Pune - 16. , CTS No. 997
Tel. : +91-20-2565 3442, +91-20-2565 6542 E-mail : info@teamANA.in | www.teamANA.in



Bhumi Silverio

Report No: 1

15-01-2021

Project: Bhumi Silverio

Environment Status Report

The percentage of work executed with respect to each of the activity of the entire phase.

B Building

| Sr. No. | Task/Activity | Percentage of work done |
|---------|--------------------------|-------------------------|
| 1 | Excavation | 100 % |
| 2 | 01 Number of Stilt Floor | 70 % |

Actual photographs:



D Building

The construction work for D building is not started.

Actual photographs:



Commercial Building

| Sr. No. | Task/Activity | Percentage of work done |
|----------------|---------------------------------------|--------------------------------|
| 1 | Excavation | 100 % |
| 2 | 01 Number of Slabs of Super Structure | 100 % |



Internal & External Development Works in Respect of the entire Registered Phase

| Sr. No. | Common Areas and Facilities, Amenities | Proposed (Yes / No) | Percentage of Work done | Details |
|----------------|---|-----------------------------|--------------------------------|----------------|
| 1 | Internal Roads & Footpaths | Yes | 40 % | |
| 2 | Water Supply | Yes | 50% | |
| 3 | Sewerage (Chamber, Lines, STP) | Yes | 50 % | |
| 4 | Storm Water Drains | Yes | 50 % | |
| 5 | Landscaping & Tree Planting | Yes | 20 % | |
| 6 | Street Lighting | Yes | 20 % | |
| 7 | Community Buildings (Club House) | Yes | 5 % | |
| 8 | Treatment and disposal of sewage and Sullage Water | Yes | 0 % | |
| 9 | Solid Waste Management and Disposal | Yes | 0 % | |
| 10 | Water Conservation, Rain Water harvesting | Yes | 20 % | |
| 11 | Energy management | No | 0 % | |
| 12 | Fire Protection and Fire safety requirements | Yes | 10 % | |
| 13 | Electrical Meter Room, Sub Station, Receiving station | No (Existing) | 50 % | |



Thank You.



पिंपरी चिंचवड महानगरपालिका
निगडी ४४.
फ क्षेत्रीय कार्यालय (पापु विभाग)
क.क्षे.का/पापु/४/कावि/२५० /२०२०
दिनांक - २५ /०९/२०२०

प्रति,

Applicant Name

अविनाश नवाथे

Architect Name :

अविनाश नवाथे आर्किटेक,

सातवा मजला, मंत्री स्टर्लिंग, माणिकचंद गॅलरीज जवळ, एस.बी रोड च्या मागे, शिवाजी नगर, पुणे १६

विषय: पर्यावरण नाहरकत प्रमाणपत्रासाठी पाणीपुरवठा विभागाकडील ना हरकत प्रमाणपत्राचा दाखला मिळणे बाबत...

संदर्भ: अविनाश नवाथे यांच्याकडील दिनांक ०४/०३/२०२० चे पत्र
टोकन क्र.१०३३१९२०००१३८२४

उपरोक्त विषयास अनुसरून संदर्भिय पत्रान्वये आपण नियोजित गृहसंकुल मौजे चिखली, गट नं.११४ पै, १२४, १२५, १२६, १२७ पै यांच्या प्रस्तावित सदनिका व वाणिज्य प्रकल्पासाठी पर्यावरण ना हरकत प्रमाणपत्रासाठी दाखला मिळणेबाबत अर्ज केला आहे. आपल्या ५१३ सदनिका व ५५०.८१ चौ.मी वाणिज्य क्षेत्र यांस एकूण ८८६३८५ लि. प्रति दिन पाण्याची आवश्यकता आहे. बांधकाम पूर्ण झालेनंतर मनपामार्फत पाणीपुरवठा उपलब्धतेनुसार सदर प्रकल्पास पाणीपुरवठा करणेत येईल. उर्वरित पाण्याची मागणी आपण पुर्नवापर (Recycling) केलेल्या पाण्याद्वारे पूर्ण करावी.

सदरचा दाखला पर्यावरण ना हरकत प्रमाणपत्रासाठी देणेत येत असून सदरचा नाहरकत दाखला अर्जदाराचे दिनांक २३/०६/२०२० च्या हमीपत्रातील अटीस अधिन राहून देण्यात येत आहे. महानगरपालिकेचे टप्पा क्र.५ व ६ पूर्ण होईपर्यंत (भामा आसखेड व आंध्रा प्रकल्प) विकसकाने सदनिका प्रकल्पातील धारकांना स्वखर्चाने पाणीपुरवठा करणेत येईल. या अटीवर सदरचे पर्यावरण ना हरकत प्रमाणपत्र देणेत येत आहे. सोबत हमीपत्राची प्रत जोडली असे.

कार्यकारी अभियंता

फ क्षेत्रीय कार्यालय, पाणीपुरवठा विभाग
पिंपरी चिंचवड महानगरपालिका
निगडी ४४

प्रत - कार्यकारी अभियंता, बांधकाम परवानगी विभाग यांचे
माहितीसाठी व पुढील कार्यवाहीसाठी



पिंपरी चिंचवड महानगरपालिका, पिंपरी-१८,
क' क्षेत्रीय, जलनिःसारण विभाग
जा क्र. पापु/जनि/कक्षे/१६८ /२०२०
दिनांक:- ०४/०५/२०२०.

प्रति,

आर्कि अविनाश नवाथे तर्फे भूमी शेल्टर्स इंडीया प्रा. लि. तर्फे श्री. डि. व्ही.गुठे
गट.नं -११४ (पार्ट) +१२४+१२५+१२६+१२७ (पार्ट)
चिखली

विषय:- पर्यावरण ना हरकत प्रमाणपत्रासाठी जलनिःसारण विभागाचा ना हरकत
दाखला देणेबाबत.

संदर्भ:- १) INWD/EC/CHK / /18 नकाशाप्रमाणे

आपण दि. ०४/३/२०२० रोजी पर्यावरण ना हरकत प्रमाणपत्रासाठी या विभागाकडे
जलनिःसारण विभागाचा ना हरकत दाखला मिळणेकामी अर्ज केला आहे. सदर गृहप्रकल्प मौजे चिखली बो-
हाडेवाडी गट नं. - गट.नं -११४ (पार्ट) +१२४+१२५+१२६+१२७ (पार्ट)

आपण नकाशात सादर केले प्रमाणे भुखंडाचे निव्वळ क्षेत्र १९४५९.३२ चौ. मी एवढे असून सद्यस्थितीत
नियोजित निवासी सदनिका ५१३, (२७४६९.५५) चौ. मी निवासी व ५५०.८३ चौमी व्यापारी बांधकाम क्षेत्र
इतके आहे. एकूण बांधकाम क्षेत्र २८०२०.३८ चौमी आहे.

महाराष्ट्र प्रदुषण नियंत्रण मंडळाचे परिपत्रकानुसार जागेचे निव्वळ क्षेत्रफळ अथवा
बांधकामाचे क्षेत्र २००००.०० चौ. मी पेक्षा जास्त असलेस महाराष्ट्र नियंत्रण मंडळ यांचे कडील Consent to
Establish घेऊन मैलाशुद्धीकरण केंद्र बांधणे बंधनकारक आहे. सदर मैलाशुद्धीकरण केंद्रामध्ये गृहप्रकल्पातील
मैला सांडपाण्यावर प्रक्रिया करून, प्रक्रियायुक्त पाणी बागकाम व फ्लशिंगकरीता वापरण्यात यावे. तसेच
बांधकाम पूर्णत्वाच्या वेळी Consent to Operate सादर करणे बंधनकारक राहिल. उरलेले जादा पाणी मनपाचे
ड्रेनेज लाईनला जोडणेसाठी या गृहप्रकल्पाजनिक मनपाची मलवाहिनी उपलब्ध आहे.

सबब आपण सादर केलेल्या अर्जास अनुसरून पर्यावरण ना हरकत प्रमाणपत्रासाठी आपणास
कळविणेत येत आहे.

विशेष अटी:-

- १) प्रत्यक्ष काम सुरू करणेपूर्वी ड्रेनेजचे नकाशे मान्य करून घ्यावे लागतील व ड्रेनेज डेव्हलपमेंट चार्जेस
भरल्याशिवाय ड्रेनेज पूर्णत्वाचा दाखला मिळणार नाही.
- २) पावसाळ्यातील पाण्याची व्यवस्था स्वतंत्रपणे करणेत यावे व ते पाणी जलनिःसारण नलिकेस जोडू
नये.
- ३) सदर इमारतीचे बेसमेंटचे कनेक्शन मनपा जलनिःसारण नलिकेस जोडू नये.
- ४) प्रकरणासोबत जोडणेत आलेल्या नकाशामध्ये आपल्या मार्फत दर्शविणेत आलेल्या बांधकाम प्रकल्पामधील
बांधणेत येणा-या मैलाशुद्धीकरण केंद्राची कार्यपद्धती व प्रक्रियायुक्त सांडपाण्याची गुणवत्ता महाराष्ट्र
प्रदुषण नियंत्रण मंडळाच्या मानकानुसार असल्याबाबत पूर्ण शहनिशा करण्याची जबाबदारी
राहिल. तसेच सदर ठिकाणी बांधणेत येणा-या मैलाशुद्धीकरण केंद्राची तांत्रिक माहिती पूर्णत्वाच्या वेळेस
मनपास देणे बंधनकारक राहिल.
- ५) नकाशात दर्शविणेत आलेल्या मैलाशुद्धीकरण केंद्राचे (STP) ठिकाणामध्ये (Location) मनपाच्या
परवानगी शिवाय बदल करणेत येऊ नये. सदर ठिकाणी बांधणेत आलेल्या STP ची चालन, देखभाल व
दुरुस्तीची बाबतची अट सदनिका धारकांचे करार नाम्यामध्ये व सोसायटी स्थापनेनंतर सोसायटी
हस्तांतरण करारनाम्यामध्ये नमुद करून त्याची एक प्रत या विभागास सादर करणे बंधनकारक राहिल.
तसेच पर्यावरण विभागाकडील (Environmental Clearance) ना हरकत दाखला सादर करणे
आवश्यक राहिल.
- ६) सदर बांधकाम प्रकल्पामध्ये किचन व बाथरूम मधील पाण्याचे पुनःवापर व पुनः चक्रिकरण करणेच्या
अटीवर जादा पाण्याची व्यवस्था बांधकाम विकास नियंत्रण नियमावलीनुसार ड्रेनेज बाबत कार्यवाही
करणेत यावी.

- ७) सदर गृहप्रकल्पाकरीता बांधणेत आलेल्या STP चे प्रक्रिया केलेले सांडपाणी गार्डनींग , फ्लशिंग आणि कॉमन फ्लोअर वॉशिंग करीता वापरणेत यावी. जादा पाण्याची व्यवस्था बांधकाम विकास नियंत्रण नियमावलीनुसार ड्रेनेज बाबत पुढील कार्यवाही करणेत यावी.
- ८) सदर बांधकाम प्रकल्पासाठी सादर केलेल्या नकाशानुसार STP ची क्षमता देणेत आलेली आहे. सदर बांधकाम प्रकल्पामध्ये भविष्यात सदनिकांचे संकेत वाढ झालेस अथवा व्यापारी क्षेत्रात वाढ झालेस MPCB च्या नियमानुसार वाढीव क्षमतेचा STP बांधणेची जबाबदारी ही विकसकाची राहिल.
- ९) नियोजित बांधकामासाठी विकसकास सुधारीत परवानगी घ्यावी लागत असलेस त्यासाठी जलनिःसारण विभागाचा सुधारीत ना हरकत दाखला घेणे बंधनकारक राहिल.
- १०) सदर बांधकाम प्रकल्पामध्ये सदनिका ५१३, (२७४६९.५५) चौ. मी निवासी व ५५०.८३ चौमी व्यापारी बांधकाम पुरेशा क्षमतेचे मलशुद्धीकरण केंद्र महाराष्ट्र प्रदुषण नियंत्रण मंडळाचे Consent to Establish घेऊन बांधणेत यावे.

सोबत जोडलेल्या अटी आपणास बंधनकारक राहिल.

सोसायटी /अपार्टमेंटची नोंदणी होणेपूर्वी व हस्तांतरित केल्यानंतर विकासकासाठी नियम व अटी

- १) मैलाशुद्धीकरण (STP) केंद्रामधून प्रक्रिया केलेल्या सांडपाण्याची गुणवत्ता महाराष्ट्र प्रदुषण नियंत्रण मंडळाचे मानकानुसार ठेवण्याची जबाबदारी विकसकाची राहिल.
- २) सदर मैलाशुद्धीकरण (STP) केंद्र महाराष्ट्र प्रदुषण नियंत्रण मंडळाचे मानकानुसार चालवण्यात यावे व मानकानुसार आवश्यक त्या तपासण्या वेळोवेळी करण्यात याव्यात व तपासणी अहवालाची नोंद ठेवण्यात यावी.
- ३) सदर मैलाशुद्धीकरण (STP) केंद्रात काही बिघाड झाल्यास किंवा अडचणी आल्यास त्याची दुरुस्ती २४ तासात सदर केंद्र पूर्ववत सुरू करण्यात यावे.
- ४) सदर मैलाशुद्धीकरण (STP) केंद्राबाबत कोणत्याही प्रकारची तक्रार आल्यास त्याची संपूर्ण जबाबदारी विकसकाची राहिल.
- ५) सदर मैलाशुद्धीकरण (STP) केंद्राची वेळोवेळी पाहणी करण्याचा म.न.पा. स अधिकार राहिल.
- ६) सदर मैलाशुद्धीकरण (STP) केंद्राबाबत महाराष्ट्र प्रदुषण नियंत्रण मंडळ यांनी हरकत घेतलेस सदर बाबतची सर्वस्वी जबाबदारी लिहून देणारा /विकासकावर राहिल ,त्याची म.न.पा.स तोशीस लागू देणार नाही.
- ७) भविष्यामध्ये सदर भागीदार ड्रेनेज लाईन कार्यान्वित झाल्यानंतर बांधकामासाठी वापर करून अतिरिक्त प्रक्रियायुक्त पाण्याची व्यवस्था महाराष्ट्र प्रदुषण नियंत्रण मंडळ यांच्या नियमानुसार करण्यात यावी. तसेच बांधकाम विकास नियंत्रण नियमावलीनुसार ड्रेनेज बाबतची पुढील कार्यवाही करण्याची जबाबदारी विकसकाची राहिल.
- ८) सदर मैलाशुद्धीकरण (STP) केंद्राचे चालन /संपूर्ण देखभाल व दुरुस्ती तसेच आवश्यक ते कर्मचारी यांची सोसायटी /अपार्टमेंटचे राहिल. याबाबतची अट सोसायटी /अपार्टमेंट हस्तांतरण करारनाम्यामध्ये नमूद करण्याची जबाबदारी विकसकाची राहिल. सोसायटी /अपार्टमेंट हस्तांतरण करारनाम्याची प्रत म.न.पा चे जलनिःसारण भागाकडे देणे विकसकावर राहिल. म.न.पा .स तोशीस येऊ देणार नाही. याबाबत कोणताही कायदेशीर बाब उद्भवल्यास त्याची संपूर्ण खर्चासह जबाबदारी विकसकाची राहिल.
- ९) विद्युत पुरवठा खंडित झाल्यास मैलाशुद्धीकरण (STP) सतत कार्यान्वित राहण्यासाठी स्वतंत्र जनरेटची व्यवस्था करण्याची जबाबदारी विकसकाची राहिल.
- १०) मैलाशुद्धीकरण (STP) केंद्र कार्यान्वित झाल्याशिवाय पूर्णत्व नाहरकत दाखल्याची मागणी करता येत नाही. यातील सर्व मजकूर मान्य राहिल.

 उपअभियंता
 क क्षेत्रीय कार्यालय
 जलनिःसारण विभाग
 पिंपरी चिंचवड महानगरपालिका
 पिंपरी -१८

प्रत:- मा. उपशहर अभियंता, बांधकाम परवानगी विभाग
 यांचे माहितीसाठी सविनय सादर.

| | | |
|----------|---|-----------------|
| Token No | = | 103317180012596 |
| Date | = | 23/01/2018 |
| File No | = | 782 |

Pimpri Chinchwad Municipal Corporation
Fire Department.
No. Fire / 02 / 5B / WS / 309/2018
Date. 9 / 2 / 2018

Final Fire No Objection Certificate for Buildings

With reference to the application dt. 23/01/2018 of the under mentioned applicant, technical site inspection had been carried out by the concerned Sub Officer of the department in accordance with the submitted plan copies and documents.

Final Fire No Objection Certificate is being herewith issued under Rule 6.2.6.1; 6.7.2 & 19, and other applicable rules of DC Rules of PCMC, NBC 2005 – Part IV , GR.Dt.10/03/2010 and Maharashtra Fire Act 2006 & Rules 2009. Concerned rules and provisions mentioned in the above and others if any will be applicable and binding.

Site Address –
(01 Bldg.) 'Bhumi Silverio Bldg-C- Wing C1,C2,C3'
Gat No. 114(P)+124+125+126+127(P), Chikhali, Pune

Fire System Installer-
M/s Om Sai Fire Systems
Ganeesham- D, Office-01, Pimple Saudagar, Pune.

Permissible FSI Area – 17159.96 Sq.Mtrs.

Plot Area– 19306.87 Sq.Mtrs.

| Bldg Nos. | Height (G.L) | Builtup Area | Gross Builtup Area | No. of Floors | Occupancy Type |
|------------------|--------------|------------------|--------------------|---------------|----------------|
| Wing C1,C2,C3 | 38.55 Mtrs | 6561.51 Sq. Mtrs | N/A | GP+12 | Residential |

This Final NOC is issued as per layout and building plans sanctioned, Fire Supplier's Certificate from fire prevention point of view. Rules governing of department are applicable from time to time.

| | |
|-----|---|
| 1. | Side margins being maintained, to be kept totally free of obstructions and motorable, all the time as per DC Rule 10.6(b). No temporary/permanent structure of any kind, any hurdle creating use or gate/wall of any sort to be built in side margins. |
| 2. | All Exit ways (Staircases, Passages, Lobbies, etc) shall be kept free of obstructions at all times and no building shall be altered so as to reduce the number width or protection of exits as per DC Rule 17.1.(c)(d) |
| 3. | Emergency Contact Numbers Board of Fire, Ambulance, Police, MSEB, etc being displayed at the gate. |
| 4. | Overhead Fire water tank being provided of 20,000 ltrs capacity as required. |
| 5. | Underground Fire tank being provided with fire service Inlet at accessible position. |
| 6. | Riser cum Down Comer System of 6" dia, Terrace Pump and Ground Pump and Hose Pipes, Hydrant Valves, alternate floor Hose Reel, Nozzle, etc. being provided |
| 7. | M.C.P. and P.A. Communication System with Talk Back facility being provided. |
| 8. | Fire Staircase being provided with Fire Doors for as per requirement. |
| 9. | Fire Lift/Fire cum Stretcher/Hospital Lift (large) with fireman's switch being provided |
| 10. | Independent Refuge Area 'C1,C2,C3' – 208.57 Sq.mts, 8th floor & 12th floor , being provided at the front & conspicuously marked for identification |
| 11. | ABC Type Fire Extinguishers , 4 kg capacity (ISI Mark) – 42 nos. Provided. |
| 12. | Courtyard/Parking Hydrants with one 4 way Collecting Head for each wing being provided apart from the building in front, at accessible position |
| 13. | Fire Fighting Pump Installation and Emergency Lighting System , Fire Lift being connected to Independent Backup System, to be kept in operation for all the time |

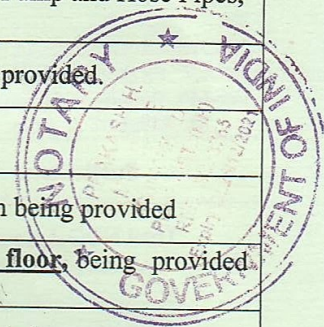

NOC Remarks if any

- 1) Sub. to Prov Fire NOC No.Fire/5J/WS/1013/2012, Dt. 06/03/2012.
- 2) Sub. to (Rev.I) Prov Fire NOC No.Fire/5J/WS/965/2013, Dt. 14/11/2013.
- 3) Subject to Sanctioned Plan No. BP/Chikhali/45/2014., Dt. 14/08/2014.

Independent/Separate Fire NOC should be obtained for the actual use of the Special buildings for business purposes, etc as applicable (eg. Hotel, Hospital, Malls, Multiplexes, Schools, Theatres, Gas Agencies, Petrol Pumps, etc)

The Builder/Promoter/Architect, etc. to enter Annual Maintenance Contract with certified Fire Agency for minimum period of 3-5 years towards, efficient working of the system and to hand over the entire Fire Fighting system in operating condition to the Society/Apartment/Occupier, officially during the Tenement/Society handing over process.

It is the sole responsibility of the occupier to maintain and keep in good working conditions all the time, the installed fire fighting system and keep in use and impart training of the use of system to the tenements, as per Sec. 3(1) of Mah. Fire Act – 2006, failing of which the NOC shall be deemed cancelled.

The Occupier / Fire Agency shall submit Report/Certificate for proper maintenance and good working condition of the fire fighting system every year to this office as per Sec.3(3) of Mah. Fire & Life Safety Act – 2006.

The Fire Office reserves the right of entry for surprise visit and inspection of the system as per the Sec. 5(1) of the Mah. Fire & Life Safety Act - 2006.

Fire Dept reserves the right to alter, modify, revise or revoke the NOC.

Any changes, internal or external encroachments, alterations, non abidance, negligence, dangerous unlawful act done towards above conditions mentioned, shall immediate treats the NOC as automatically cancelled and will stand invalid.

*Difference of Fees amount if any, found during Audit, in future, will be recovered from the Applicant / Occupier.

TRUE COPY

PRAKASH H. MENGADE

NOTARY

GOVT. OF INDIA

Keshav Nagar, Chinchwadgaon.

PUNE - 411 033.

Chief Fire Officer

Pimpri Chinchwad Municipal Corporation

Pimpri, Pune-411018.

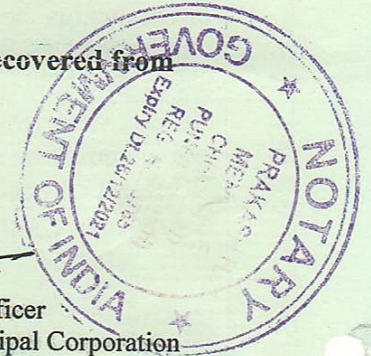

To,
M/s.Avinash Nawathe Arch.
ANA, 7th Flr., Mantri Sterling, Shivajinagar, Pune.
For-M/s. Premier Buildcon, Mr. Gajendra S.Patil
Mr. Mangesh A. Gole.

26 FEB 2018

| Particulars | Fire NOC Fees (Rs.) | Receipt No.& Date |
|------------------|---------------------|---------------------------------|
| Total NOC Amount | 11,62,300/- | ----- |
| Previous Paid | -3,01,200/- | 2169, Dt.14/03/2012 |
| | -8,22,200/- | 2207, Dt.16/11/2013 |
| Amount Paid Rs. | 38,900/- | 303317180022540, Dt. 09/02/2018 |